

Soils Map

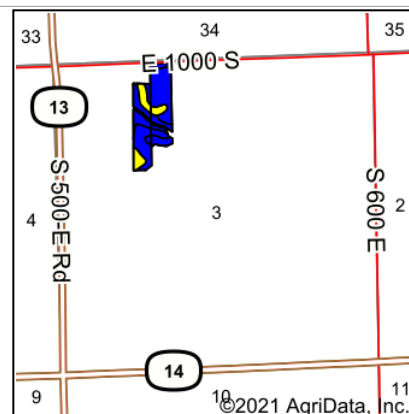

State: **Indiana**
 County: **Kosciusko**
 Location: **3-30N-7E**
 Township: **Jackson**
 Acres: **20.05**
 Date: **11/8/2021**

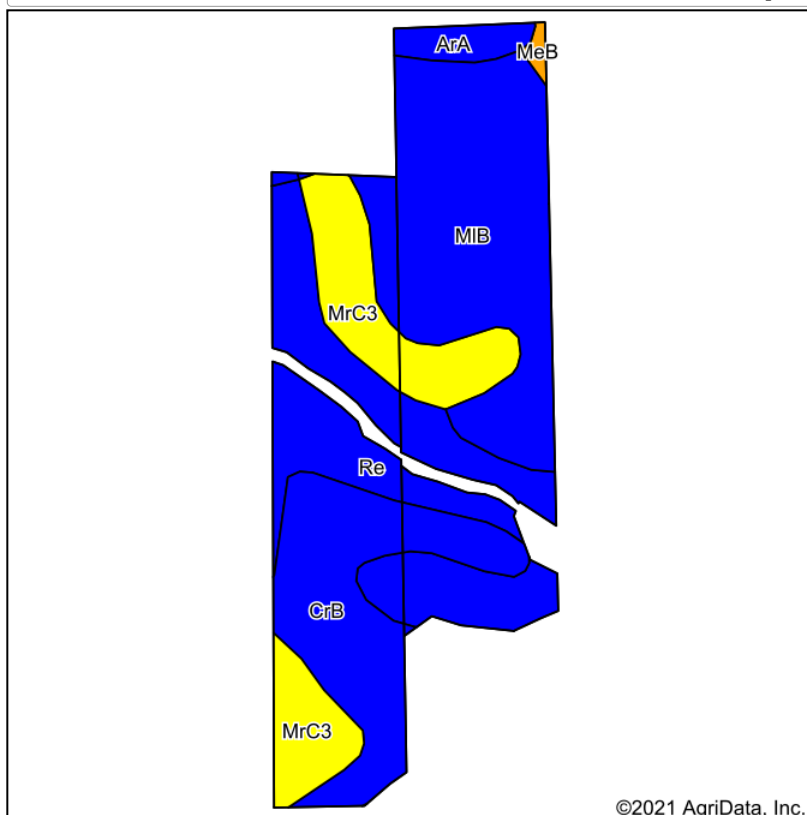

Maps Provided By:



Soils data provided by USDA and NRCS.

©2021 AgriData, Inc.

Area Symbol: IN085, Soil Area Version: 24								
Code	Soil Description	Acres	Percent of field	Non-Irr Class Legend	Non-Irr Class *c	Corn Bu	Soybeans Bu	*n NCCPI Soybeans
MIB	Miami loam, 2 to 6 percent slopes	6.59	32.9%		Ile	144	48	47
Re	Rensselaer loam, 0 to 1 percent slopes	5.29	26.4%		IIw	167	49	81
CrB	Crosier loam, 1 to 4 percent slopes	4.17	20.8%		Ile	155	50	55
MrC3	Miami clay loam, Saginaw lobe, 6 to 12 percent slopes, severely eroded	3.33	16.6%		IVe	110	39	25
ArA	Aubbeenaubbee sandy loam, 0 to 2 percent slopes	0.57	2.8%		IIw	135	44	65
MeB	Metea loamy fine sand, moderately slowly permeable, 2 to 6 percent slopes	0.10	0.5%		IIIe	110	39	45
Weighted Average					2.34	146.3	47	*n 54.5

*n: The aggregation method is "Weighted Average using all components"

*c: Using Capabilities Class Dominant Condition Aggregation Method

Soils data provided by USDA and NRCS.